

Key Features

- Each channel supports up to 4CIF encoding
- Dual stream
- Anti-shock technology
- 2 2.5" pluggable SATA cages
- Built-in CDMA/WCDMA/CDMA 2000 wireless network modules
- Built-in GPS Module
- Built-in G-sensor

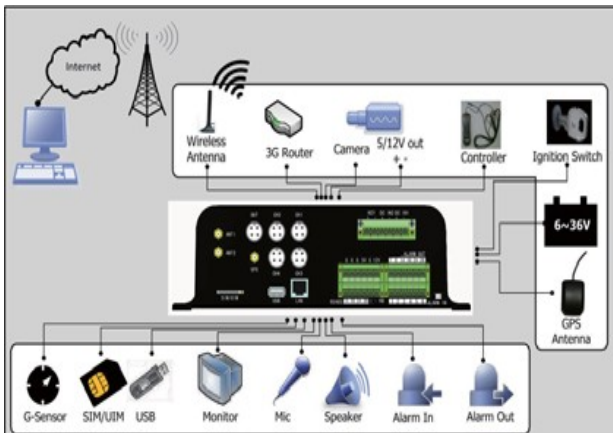

The MTSC-8104 Mobile DVR is a 4 channel DVR specially designed for mobile monitoring applications. With its high performance DaVinci processors and advanced H.264 video codec. The MTSC-8104 Mobile DVR delivers real-time CIF resolution video for 4 channels. It also applies patented premium anti-shock technology, exquisite and portable design, as well support two pluggable 2.5" hard disk, which meets the strict requirement in various mobile surveillance applications such as bus, taxi, train, vault truck, and vans among others.



Specifications

Video/Audio Input	Video Compression:	H.264
	PAL/NTSC Adaptive:	Support
	Video/Audio Input:	4-ch
	Video Input Interface:	Aviation Connector (1.0Vp-p, 75Ω)
	Audio Compression:	OggVorbis
Video/Audio Output	Audio Input Interface:	Aviation Interface (linear electrical level, 1kΩ)
	Preview Resolution:	4CIF (PAL: 704x576, NTSC: 704x480)
	Recording resolution:	4CIF/DCIF/2CIF/CIF/QCIF
	Video output:	1-ch, Aviation Interface(1.0Vp-p, 75Ω)
	Frame Rate:	4CIF: 6fps; DCIF: 12fps; 2CIF: 15fps; CIF: 25(P)/30(N) fps
	Video Bit Rate:	32Kbps~2048Kbps, or user-defined (Max.8Mbps)
	Stream Type:	Video/Video&Audio
	Audio Output:	1-ch Aviation Interface (Linear electrical level, 600Ω)
	Audio Bit Rate:	16kbps
	Hard Disk Driver	Interface Type:
Capacity:		Each interface supports up to 2TB capacity
Technical Patent:		Hard disk vibration-proof and bracing technology
External Interface	Network Interface:	1 RJ45 10M/100M adaptive Ethernet Interface
	3G antenna interface:	2 antennas, SMA interface
	USB Interface:	1 USB interface, USB 2.0
	Serial Interface:	1 RS-485 interface
	Alarm Input/Output:	7-ch input, the 8th channel is reserved/2ch
	Remote Control:	IR Remote Control
	GPS:	Built-in GPS Module, 1 antenna, SMA interface
	General	Power Input:
Power Output:		12V/5V DC; build-in resettable fuse
Power Off Delay:		Shut down delay after ignition off (5min~6h)
Schedule On/Off:		Daily scheduled power on/off (00:00~24:00)
Temperature/Humidity:		-15°C~+55°C(5°F~131°F)
Dimension:		210(D)x236(W)×73mm(H)(8.27"(D)x9.29"(W)×2.87"(H))
Weight:		≤3000g (6.61lbs)